



THE **PARK**

6521 COLLEYVILLE BOULEVARD,
COLLEYVILLE, TX 76034

DELIVERING DECEMBER 2026



THE **PARK**

Strategically located in the DFW Airport submarket, this 83,473-square-foot development is designed to support modern business operations. The Park features three buildings with suites averaging approximately 3,600 square feet. Zoning accommodates diverse commercial uses, making it ideal for companies seeking flexibility today and scalability for tomorrow. With convenient parking and customizable finish-out opportunities, the property is well-positioned for companies seeking efficiency, accessibility, and long-term growth in DFW.

PROPERTY OVERVIEW

SQUARE FEET:	83,473 SF
AVG SUITES:	3,600 SF
BUILDINGS:	Three Buildings
ZONING:	Light Industrial + Retail
SIZE:	4.27 AC
PARKING:	1.64 / 1,000
CLEAR HEIGHT:	18"

STAY CONNECTED



Located directly off State Highway 26, The Park offers seamless connectivity to major transportation routes, ensuring efficient ingress and egress for both employees and clients.

DRIVE TIMES

 DFW INTERNATIONAL AIRPORT 🕒 16 Minutes	 I-820 🕒 15 Minutes	 I-30 🕒 20 Minutes
 DALLAS LOVE FIELD 🕒 26 Minutes	 SH 114 🕒 8 Minutes	 I-35W 🕒 20 Minutes

AT A GLANCE

SITE PLAN

The Park's functional design creates an environment built for efficiency, accessibility, and future scalability.

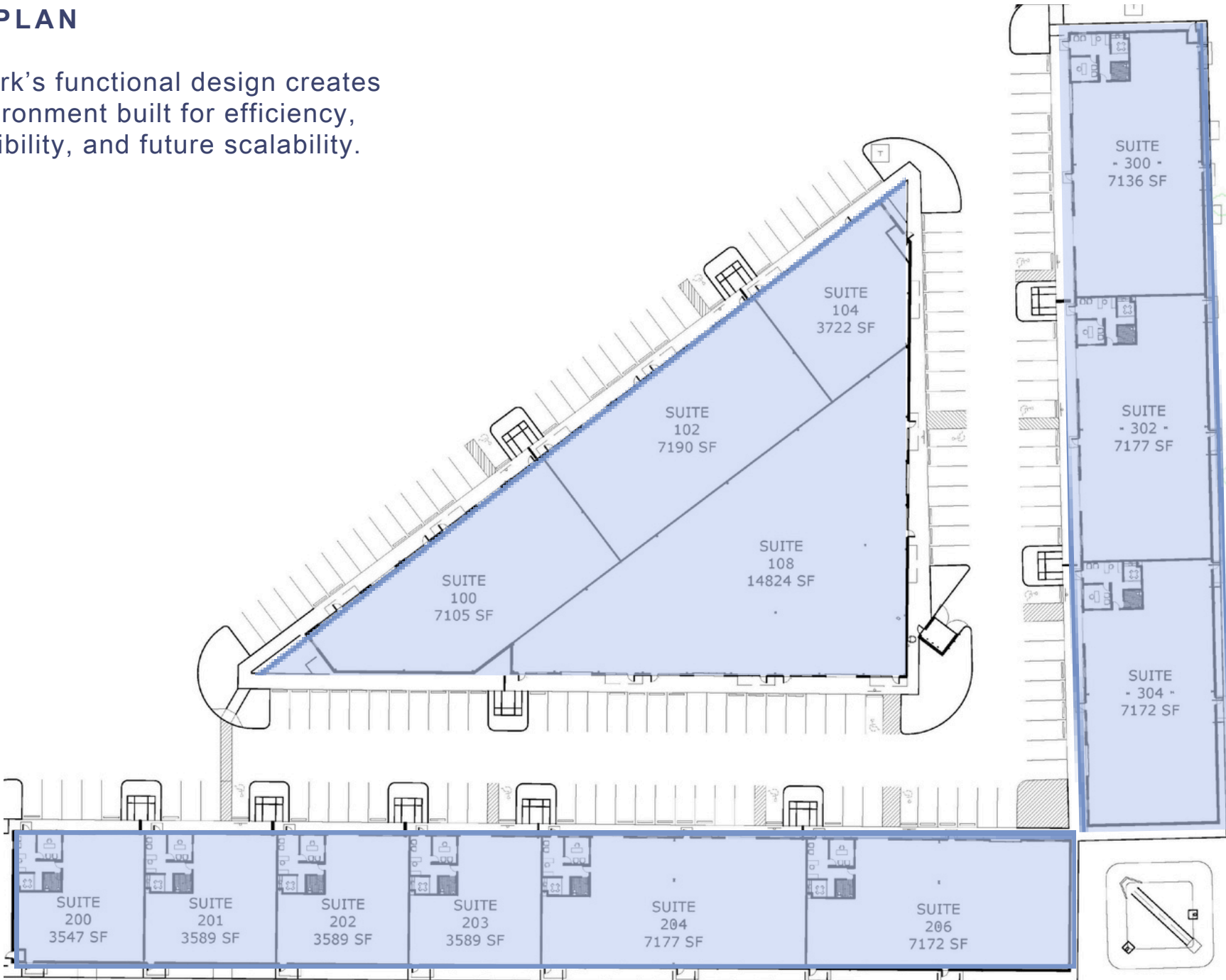

BUILDING 100

32,841 SF

Suites from 3,722 SF - 14,824 SF

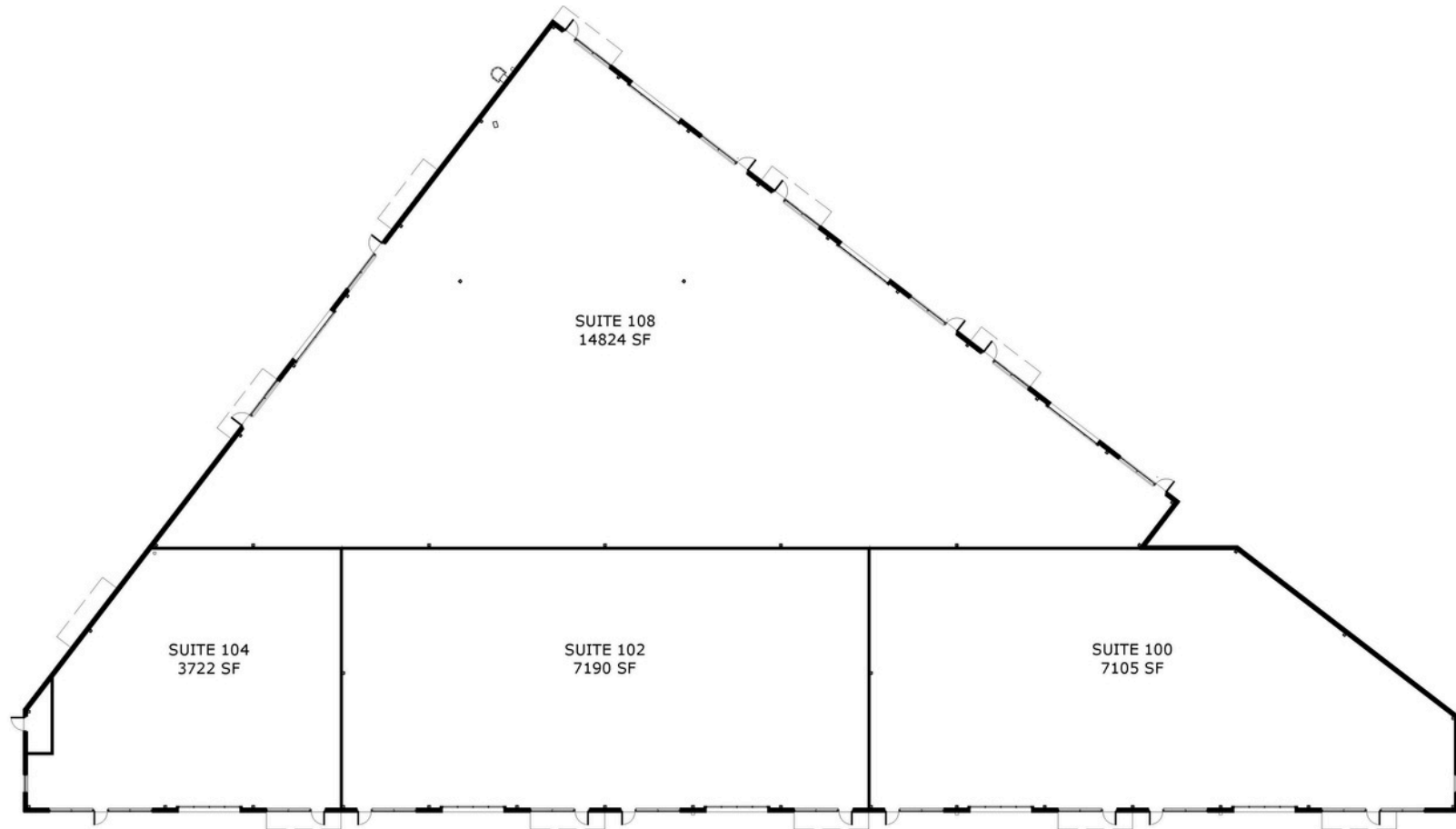

THE PARK

6521 COLLEYVILLE BOULEVARD, COLLEYVILLE, TX 76034

BUILDING 200
28,663 SF

Suites from 3,547 - 7,177 SF



BUILDING 300 21,485 SF

Suites from 7,136 - 7,177 SF



THE **PARK**

6521 COLLEYVILLE BOULEVARD,
COLLEYVILLE, TX 76034

DELIVERING DECEMBER 2026

**LEASING
INQUIRIES:**

MAC MORSE, SIOR

O | (972) 980-2917
M | (469) 556-1981

MMorse@CitadelPartnersUS.com

PAUL CLARKSON

O | (972) 980-2869
M | (972) 369-6893

PClarkson@CitadelPartnersUS.com



**CITADEL
PARTNERS**

Real Estate Advisors



Shoal Creek Capital